

FLEX 05

SUB- KILOGRAM SCALE BENCHTOP TABLET COATER

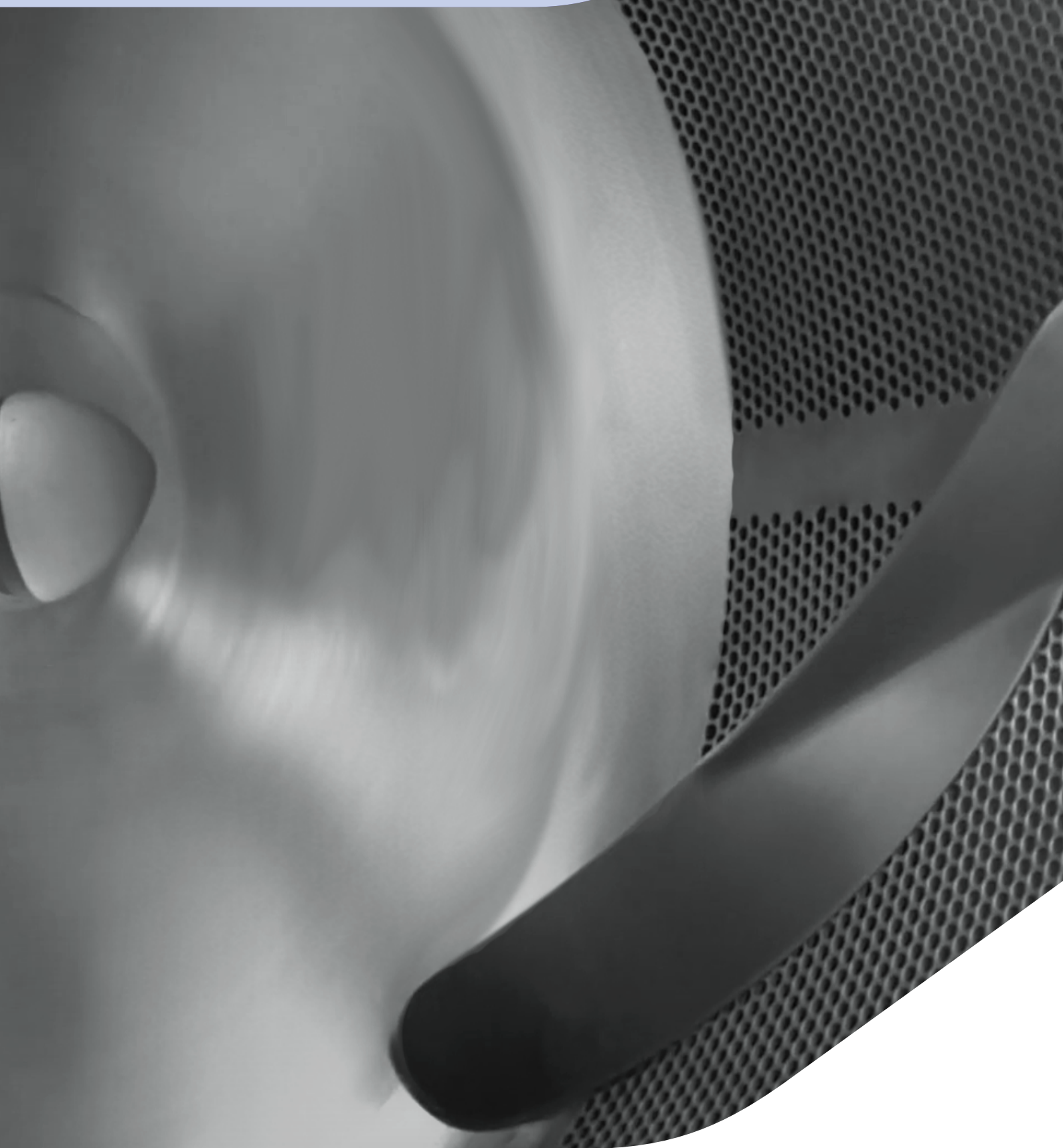

FLEX 05

The FLEX 05 is more than just a film coater - it is a practical and highly functional coating platform for most processes including those where high weight-gain, drug layers, and modified release coatings are essential.

The FLEX 05 coater includes computer-based controls with data acquisition in a compact package featuring a color touch screen HMI.

Convenient and versatile, the FLEX 05 is sure to become your indispensable coater for rapid product development, feasibility studies, and production of early stage clinical supplies - even with just a handful of tablets.

FUNCTIONALITY

- Drum capacity is 5 liters
- Fully perforated drum with anti-slide bars
- Schlick™ spray nozzle with anti-bearding cap
- Exhaust temperature set point control
- Optional independent control of atomizing and pattern air
- External spray nozzle positioning with coater door closed
- Divider plates for small batches

USABILITY

- 24 x 36 inch [610 mm x 815 mm] footprint - fits neatly on standard laboratory bench
- 10-inch color touch screen HMI
- Front access manual sampling
- Excellent visibility through front window
- Easy disassembly for cleaning at the bench or out-of-place
- Benchtop or cart-mounted for mobile applications

INNOVATION

- Coat very small quantities of cores - as few as 100 tablets
- Optional exchangeable coating unit with integrated coating chamber, drum, exhaust plenum and process port available for containment
- Complete separation of product contact area from mechanical space
- Closed transfers for off-bench loading/unloading under containment available with containment version

VERSATILITY

- Aqueous and optional solvent coating processes
- Functional and modified release coatings
- Coating with one or more drug layers
- Tablets, minitables and softgels
- Optional execution for handling potent compounds





INNOVATIVE REMOVABLE COATING CHAMBER (XCU)

- FLEX 05 with optional containment features exchangeable coating units - drum, chamber, plenum and process port
- XCU is self-connecting to the inlet/exhaust air ports and to drum drive
- Easy removal and installation for fast setups and changeovers without tools
- Integrated exhaust plenum extracts with the XCU for easy cleaning



CONTAINMENT OPTION

- Coater operates under negative pressure
- Inflatable seal
- Sanitary flanges available for closed loading and unloading
- Manual sampling and spray nozzle positioning with front process port closed
- Fully contained execution with safe change filters available

ONE COATING PLATFORM - MANY USES

- FLEX 05 is a cost effective alternative to purchasing multiple conventional-type lab coating systems
- Nozzle positioning mechanism with graduated scale for repeatable nozzle-to-bed distance and angle settings
- Peristaltic pump with precise flow control
- Schlick™ anti-bearding spray nozzle



HMI AND CONTROLS

- Process parameters are set using color touch screen HMI
- Manual control of the process with data capture
- Minimum number of control screens for ease of use
- Real time display of measured process parameters
- Real time calculation and display of Environmental Equivalency (EE) Factor using proprietary TAAC process modeling algorithm

TECHNICAL DATA

FLEX 05

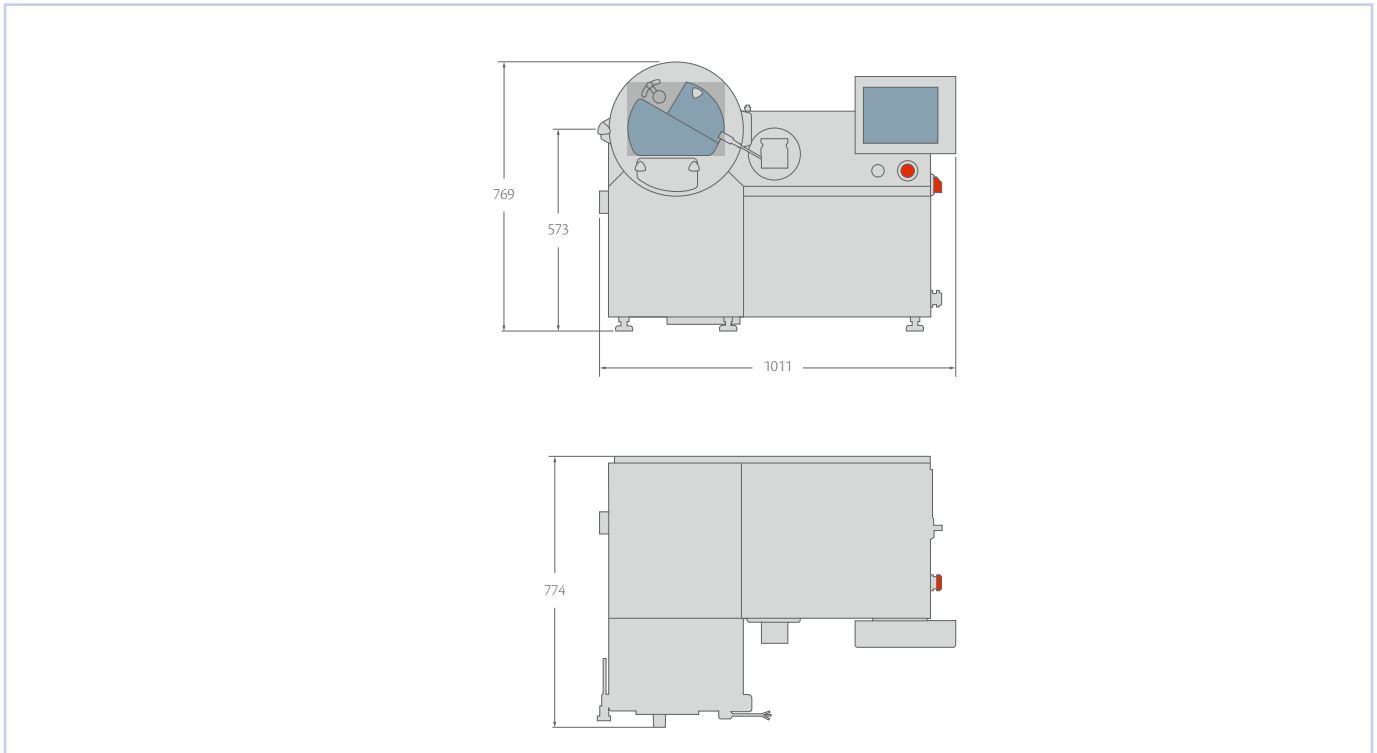

June 2021 - 990FLEX0501

THOMAS PROCESSING LLC reserves the right to make any changes to the described machine characteristics.

FLEX 05	
Overall dimensions	24" x 36" x 30" high [610 mm x 815 mm x 760 mm]
Drum volume	Up to 5 liters; ½ liter with divider plate
Drum diameter	12 in. [305 mm]
Drum speed	5 - 40 RPM
Air flow and temperature	20 – 100 CFM (45°C maximum bed temp) [35 – 170 m³/h]
Spray nozzle	Schlick™ 970 ABC
Solution delivery	Watson-Marlow peristaltic pump
Atomizing/Pattern air	20 – 45 psi at 12 SCFM [1.4 – 3.0 bar at 20 m³/h]
Controls	PLC and touch panel HMI
Electrical	8 kW @ Full Load
Compressed air supply	50 psi [3.3 bar]
Weight	280 lbs. [130 kg]

THOMAS PROCESSING LLC

200 Airport Road

Elgin, IL · 60123 USA

Tel. +1 (847) 358-5800

www.thomasprocessing.com - www.ima.it